

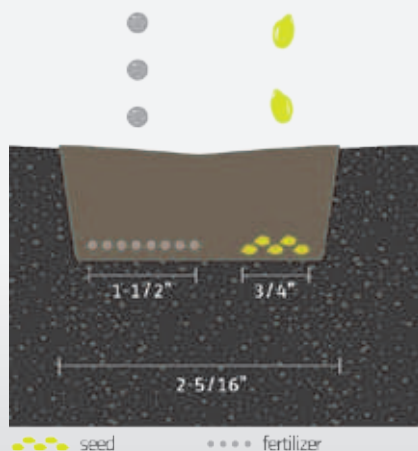

G Granular N	G P Granular + Liquid Phos	L Liquid N	L P Liquid N + Liquid Phos
680-ASY-0711G 680-ASY-0712G	680-ASY-0711GP 680-ASY-0712GP	680-ASY-0711L 680-ASY-0712L	680-ASY-0711LP 680-ASY-0712LP

THESE SIDE BAND OPENERS FIT: BOURGAULT PHD

REAR VIEW

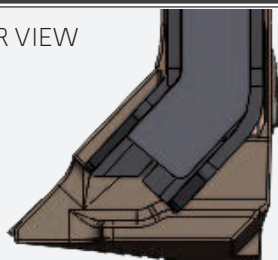

Drawing for illustration purposes only. All measurements shown are approximate. Results may vary with multiple factors including soil conditions, ground speed, application rates, fan speeds and more. In less than ideal conditions, mixing between seed and fertilizer may occur. *For more information please refer to precautions and risk factors on page 22-23.*

Seed Placement: The seed is placed in a 3/4" (19 mm) band onto a firm, unfractured seedbed. The **680 GP & LP** holders deliver the phosphorus onto the seed bed **below the seed.**

Fertilizer Placement: Fertilizer is delivered in a band off to the side (right or left) on the same level as the seed. In less than ideal conditions, mixing between seed and fertilizer may occur. *For more information please refer to precautions and risk factors on page 22-23.*

Disturbance: Unique design of the tip provides low disturbance, low draft and smoother fields.

Replaceable Tips: Cast chrome tip with carbide inserts on the nose and the wing for excellent penetration and wear resistance. Narrow carbide cutting edge on the wing for exceptional penetration. **Assemblies on this page include the tip.**

Packer Recommendations:
2-1/4" (57mm) or wider.

Opener Features: Hard facing is placed on critical wear points to ensure a long-lasting holder and proper seed placement. The streamlined holder design reduces plugging and allows for better trash clearance.

Installation Notes: When installing use bolt holes pictured in Fig. 1

ALL WINGS ON SIDE BAND OPENERS MUST BE POINTING INWARD TO THE CENTER OF THE SEEDING UNIT TO PREVENT PLUGGING WHEN TURNING. CUSTOMERS SHOULD ORDER HALF LEFT AND HALF RIGHT WING OPENERS.

For a more detailed view of these openers see page 118.

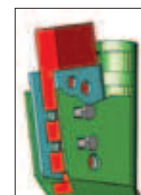

Fig.1

Looking for C-Shank Openers?

Refer to our C-Shank Section on pages 24-29.