

680-ASY-1000 & 680-ASY-1000P

SINGLE SHOOT

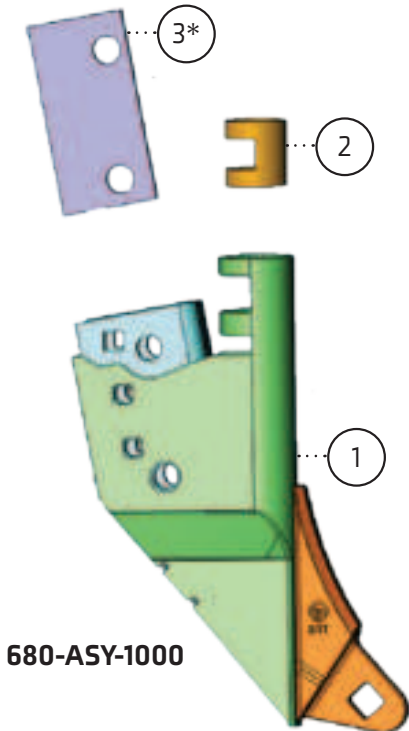

680-ASY-1000

PART#		680-ASY-1000
1	680-HLD-1000	■
2	880-BSH-1130	■
3	680-ACC-1000	■

NOTES: 680-ACC-1000 is only required when installing on Concord. **Not included in Assembly.** See page 89 for more information.

TIP OPTIONS: 200-TIP-0511, 200-TIP-0800, 200-TIP-0801, 200-TIP-0802, 200-TIP-0803, 200-TIP-0811, 200-TIP-1011, 200-TIP-2011, 200-TIP-3000, 200-TIP-3001, 200-TIP-3011, 200-TIP-4011

Tips sold separately.

See page 16-17 for more information.

680-ASY-1000P

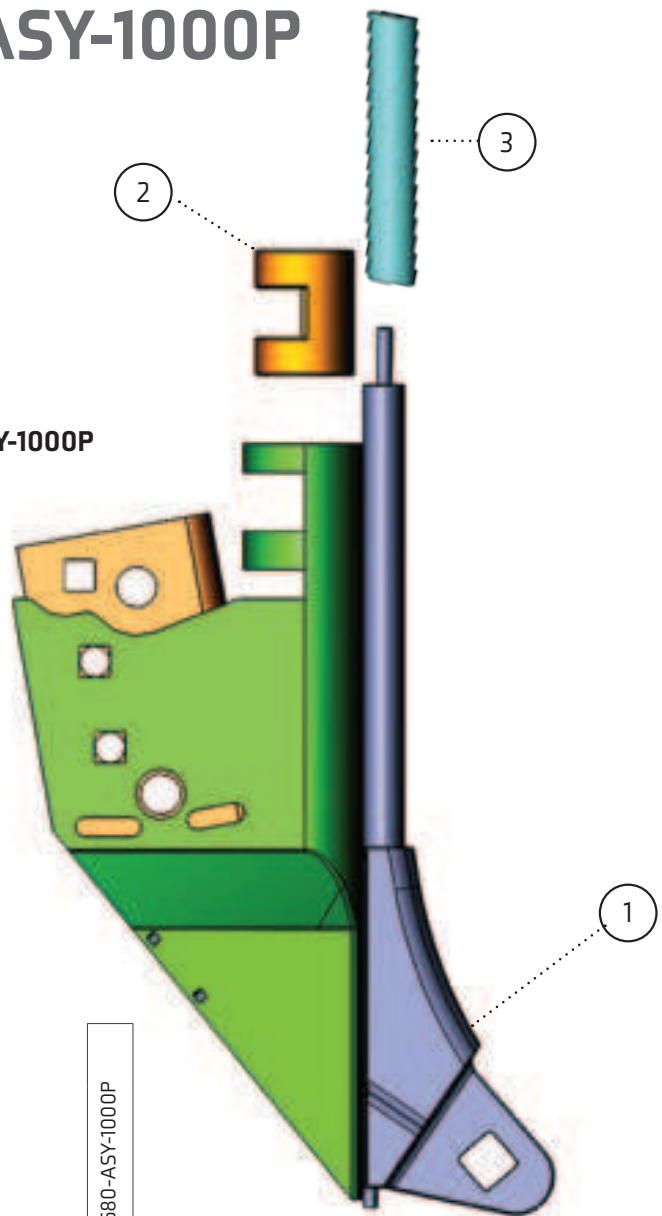

PART#		680-ASY-1000P
1	680-HLD-1000P	■
2	880-BSH-1130	■
3	680-HOS-1000	■

NOTES: 680-HOS-1000 is a 6" x 1/2" NH3 hose.

TIP OPTIONS: 200-TIP-0511, 200-TIP-0800, 200-TIP-0801, 200-TIP-0802, 200-TIP-0803, 200-TIP-0811, 200-TIP-1011, 200-TIP-2011, 200-TIP-3000, 200-TIP-3001, 200-TIP-3011, 200-TIP-4011

Tips sold separately.

See page 16-17 for more information.

880-ASY-1010

NOTE: This assembly is required to convert the standard 3/16" O.D. liquid phos tube to 1/4" I.D. liquid phosphorus delivery hoses. **Sold Separately.**

